

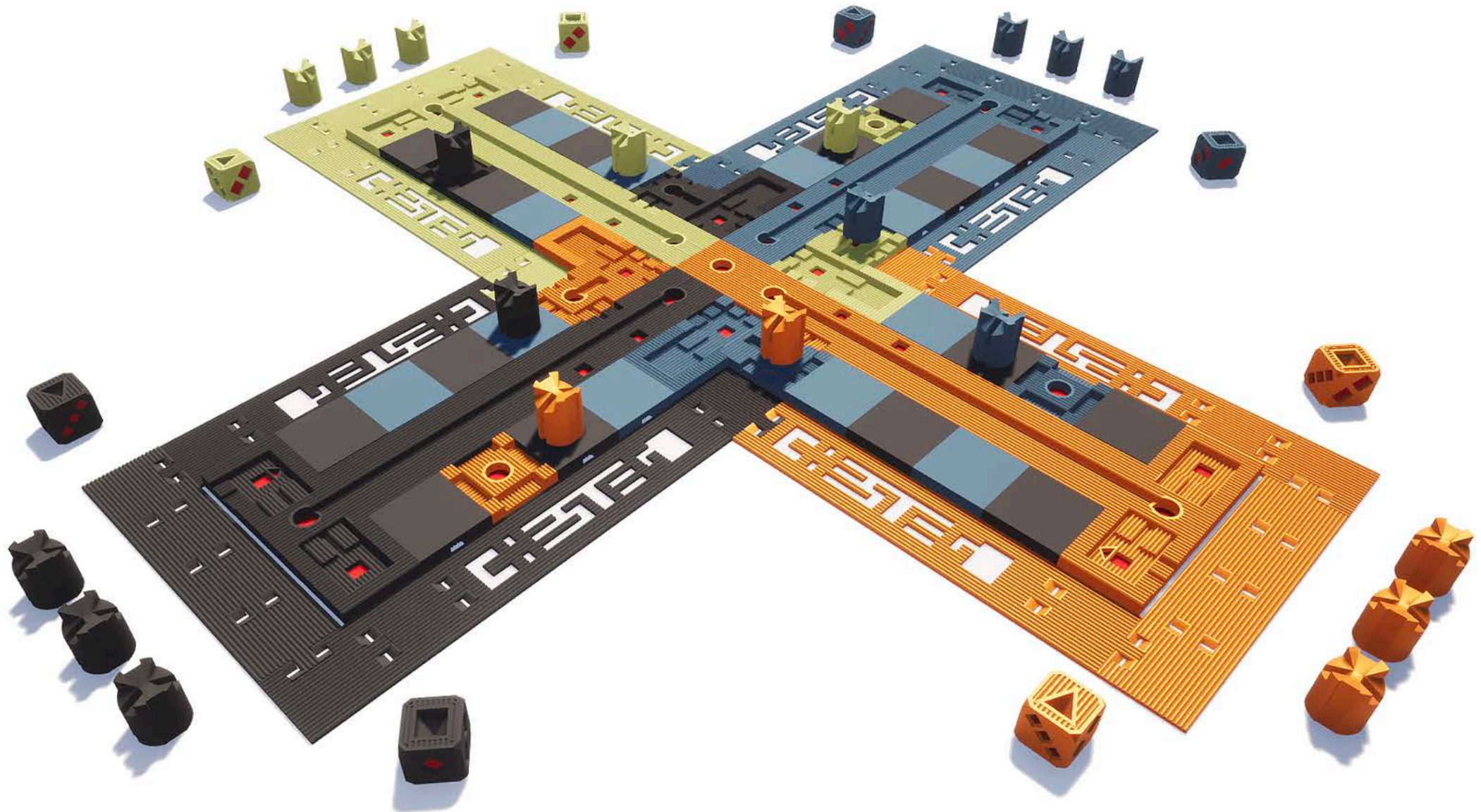

PACZ

The game Pachisi for 4 players (Requires 4 full colors with board and border pieces)



A special board and some special rules for this version of Pachisi.

RULES AND OBJECTIVES:

- Roll one Square die to see who goes 1st. A square wins or highest number. Re-roll ties.
- Players start by rolling both dice to bring in one of their 5 pieces into play. Starting at the special piece with the square and triangle. A triangle or square must be rolled.
- You roll and move down clockwise around the board.
- Landing on an enemy piece knocks them back to the start position. If there is a piece there it is knocked off the board.
- You must roll an exact number to get into one of the final home safe spots.

WIN CONDITION:

- First player to all their pieces into the home safe zone.

BOARD SETUP

- See the special board setup below

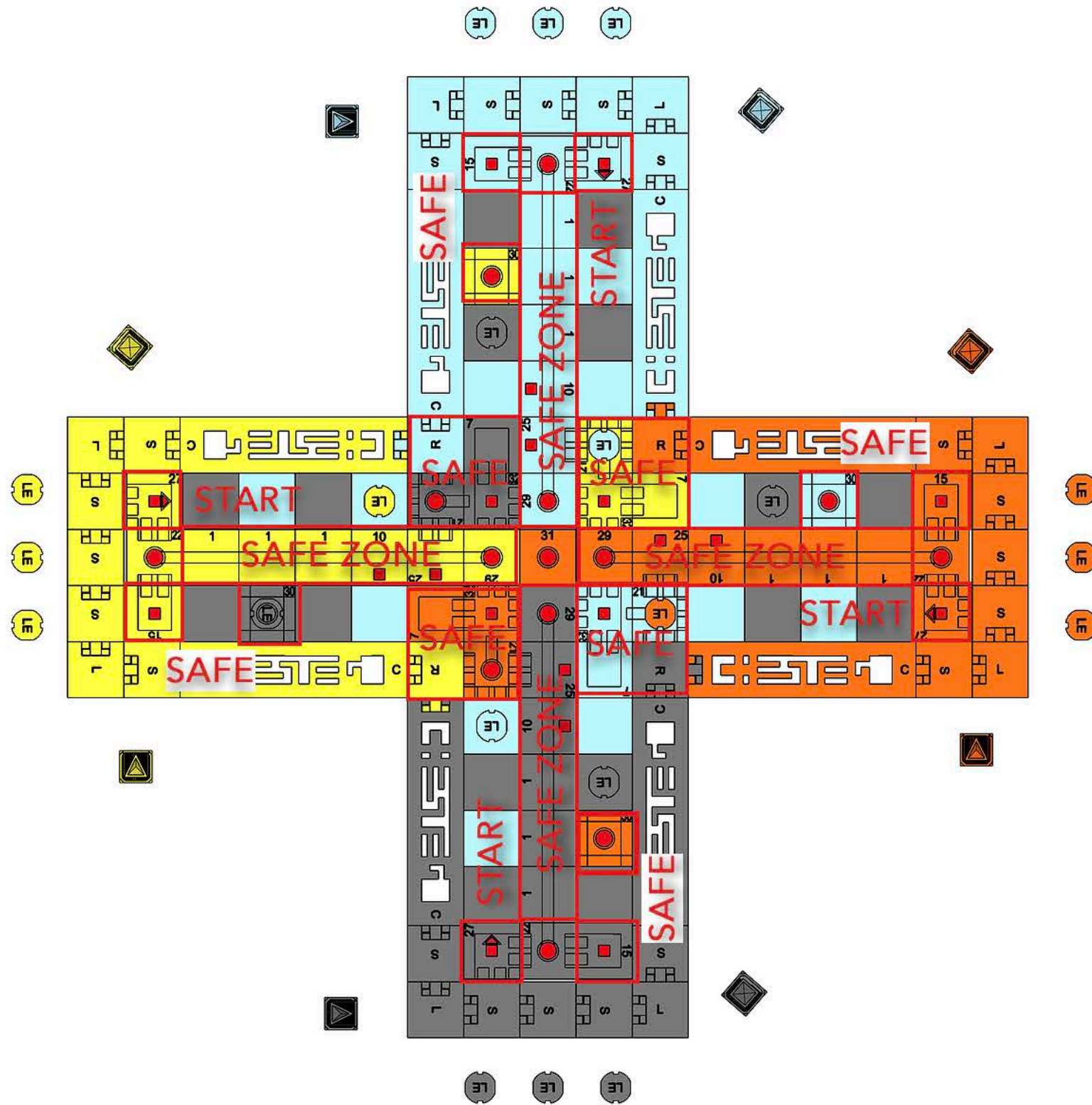

PIECE RULES

LE PURE LEAPER 5



- Moves clockwise based on the roll of the dice.
- Safe in color specific Safe spots.
- If attacked by enemy player he goes back to closest safe or start spot. If an enemy is there they get knocked back or out.

DT TRIANGLE DIE 1



- A Triangle or Square is required to start a piece at start spot.
- If you roll a Triangle, and all pieces are on the board, multiply 3 times the other number.
- If the other die is a Square you move 10 spaces if all pieces are on the board.

DS SQUARE DIE 1



- A Triangle or Square is required to start a piece at start spot.
- If you roll a Square, and all pieces are on the board, multiply 4 times the other number
- If the other die is a Triangle you move 10 spaces if all pieces are on the board.